

ARKETIPO / DIVANI-EN

FASTLOVE

designed by Giuseppe Vigano' 2023



STRUCTURE: seat: metal; back and arms: wood.

SEAT UPHOLSTERY: multi-density expanded polyurethane (D40-31+VH35-50) covered with downproof white cotton lining filled with 50% goose feathers and 50% "Fiber Ball" (polyester fibres).

BACK AND ARM UPHOLSTERY: multi-density expanded polyurethane (HR35-36) covered with synthetic lining 280gr.

BACK CUSHION UPHOLSTERY: core in expanded polyurethane (NF21-20) covered with downproof white cotton lining filled with 50% goose feathers and 50% "Fiber Ball" (polyester fibres) and coupled lining 3mm.

SPRINGING: electrowelded mesh.

SEAT HEIGHT: 44 cm.

ARM HEIGHT: 61 cm.

FEET: metal, finishes: liquid burnished, micaceous brown or oxy grey varnished.

SHELL IN VIEW: wood veneered in eucalyptus or zebrano.

Sofa with back cushions 80 cm

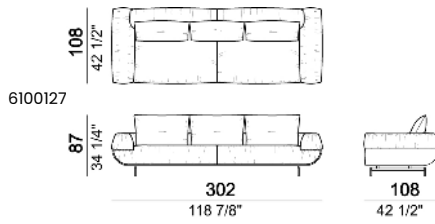
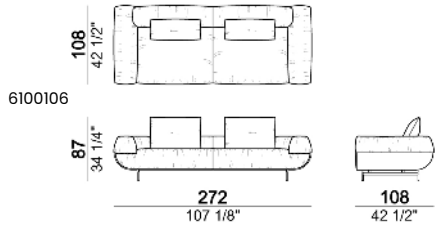
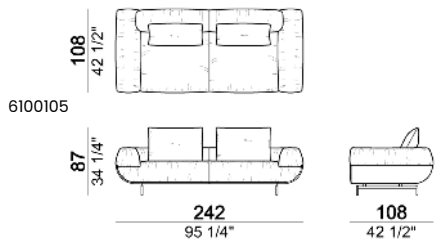

Sofa with back cushions 95 cm

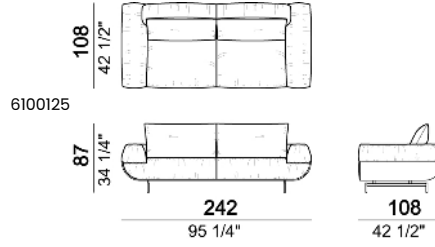
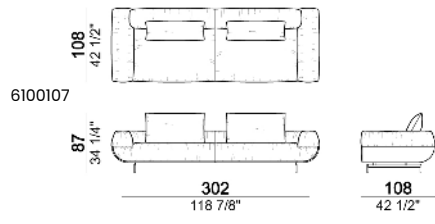

Sofa with back cushions 105 cm

